



7 Jupiter Crescent Port Macquarie, NSW



STUNNING QUALITY - EXPANSIVE LIVING - 4 CAR GARAGING!

Capturing the very essence of family living in its thoughtful design and detail, this home is spacious beyond belief!

The expansive floor plan accommodates 9 and 10ft ceilings, generous proportions throughout and a subtle palette which enhances the flow of space.

The master suite is totally separate from four other bedrooms with built-ins. Offering a balcony, walk-in robe and ensuite, this retreat is a private sanctuary within the home.

From the large laundry with external access, to the garaging where storage rooms and underhouse storage add further to the appeal of a space that can accommodate caravans, boats, e...

Price: \$650 per week

PERCIVAL
PROPERTY

Michael Percival

0404466501



MAIN FLOOR PLAN
(229 sq m Approx)

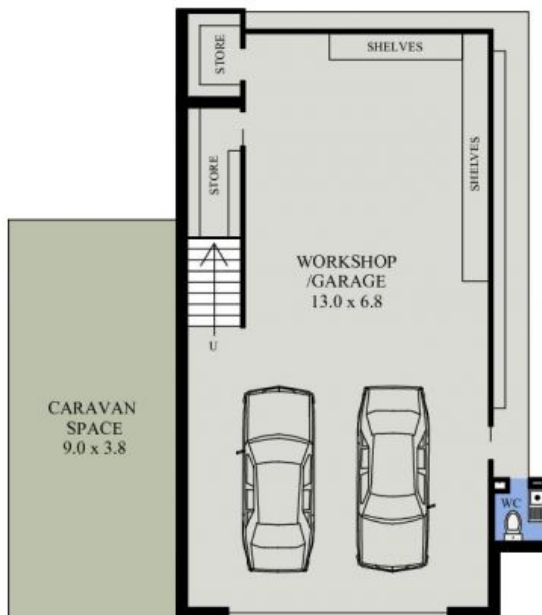

LOWER FLOOR PLAN
(95 sq m Approx)

7 JUPITER CRESCENT
PORT MACQUARIE