



7 Jupiter Crescent Port Macquarie, NSW



## STUNNING QUALITY - EXPANSIVE LIVING - 4 CAR GARAGING!

Capturing the very essence of family living in its thoughtful design and detail, this home is spacious beyond belief!

The expansive floor plan accommodates 9 and 10ft ceilings, generous proportions throughout and a subtle palette which enhances the flow of space.

The master suite is totally separate from four other bedrooms with built-ins. Offering a balcony, walk-in robe and ensuite, this retreat is a private sanctuary within the home.

From the large laundry with external access, to the garaging where storage rooms and underhouse storage add further to the appeal of a space that can accommodate caravans, boats, e...

**Price:** \$650 per week



MAIN FLOOR PLAN  
(229 sq m Approx)

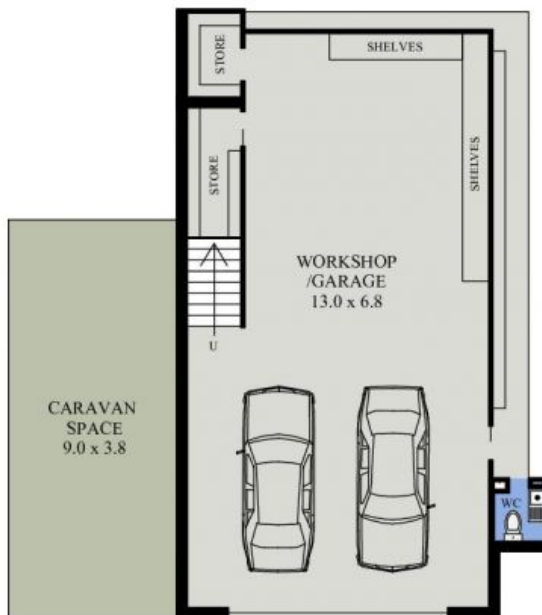

LOWER FLOOR PLAN  
(95 sq m Approx)

7 JUPITER CRESCENT  
PORT MACQUARIE