



3 Timber Ridge Port Macquarie, NSW



4



3



2

Walk to Beaches & Rainforest - Quality Home Built for Lifestyle

This is the perfect blend of indoor/outdoor spaces overlooking lovely serene gardens, a large entertaining patio and sparkling in-ground pool.

The dual level design incorporates a generous, open plan living space with casual meals flowing through to a huge granite kitchen. Abundant storage is a feature and includes a large walk-in pantry. Mid height oven, benchtop cooking and dishwasher enhance a highly functional workspace with tonnes of natural light and an outlook over an attractive poolside setting.

Beautifully presented and perfectly situated ? this spacious home is an entertainer's dream. Separation to the covered poolside entertaining patio and private lawns framed by estab...

Price: Guide \$890,000 - \$930,000

Council Rates: \$2,860.00/year (approx)



Michelle Percival

0404 466 500

Michelle Percival

0404 466 500

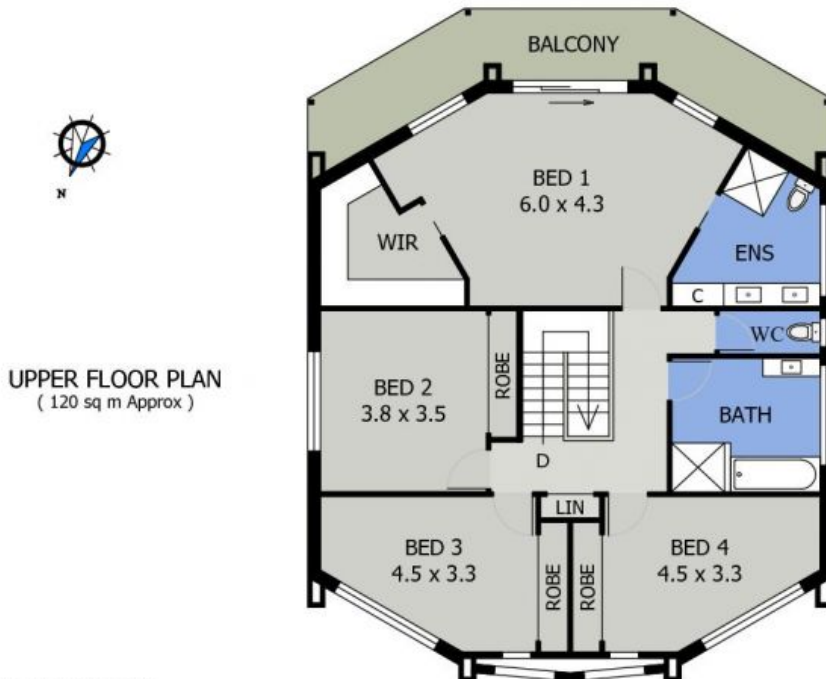

3 TIMBER RIDGE
PORT MACQUARIE