



170a Granite Street Port Macquarie, NSW

 4

 3

 2

YOUR FAST TRACK TO A FANTASTIC LIFESTYLE!

Price: \$470 per week

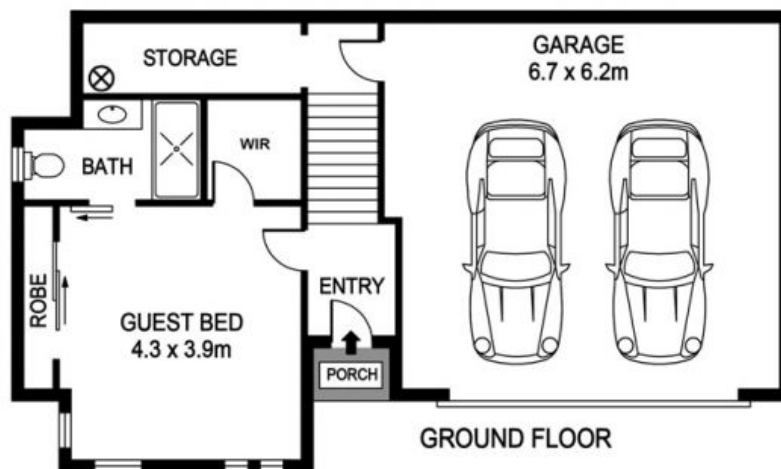

GROUND FL : 80.7m²
UPPER FL : 116.4m²
ALFRESCO : 10.0m²

170A Granite St, Port Macquarie

DISCLAIMER

PLANS SHOWN ARE FOR MARKETING PURPOSES ONLY, ALL DIMENSIONS ARE APPROXIMATE AND NOT TO SCALE. THEY ARE SUBJECT TO ERRORS AND INACCURACIES AND NO LIABILITY WILL BE ACCEPTED. INTERESTED PARTIES SHOULD MAKE THEIR OWN INQUIRES.