

One minute's walk from your door...



314 Plomer Road Port Macquarie, NSW



3



2



2

Rare Opportunity - Absolute Beachfront Lifestyle

As one of very few absolute beachfront properties, the owner in residence and holiday makers who have visited 'Sarah's Beach House' time and again are testament to the allure of this location for its lifestyle, and the home for its appeal and ease of living.

Walk the brief beach trail from your rear boundary and you are on pristine North Shore Beach, or access the local attractions including Point Plomer and the northern entrance wall to the Hastings River for their camping and fishing.

You'll be captivated by the sense of space with thanks to lofty, pitched ceilings and interiors that open widely onto a deep wraparound alfresco deck.

Open plan living and soaring ceilings are balanced by the warmth of wide plank timber floor...

Price: Guide \$850,000-\$900,000

Council Rates: \$3,100.00/year (approx)



Michelle Percival

0404 466 500

Ally Downing

0417 929 726



UPPER FLOOR PLAN
(124 sq m Approx)

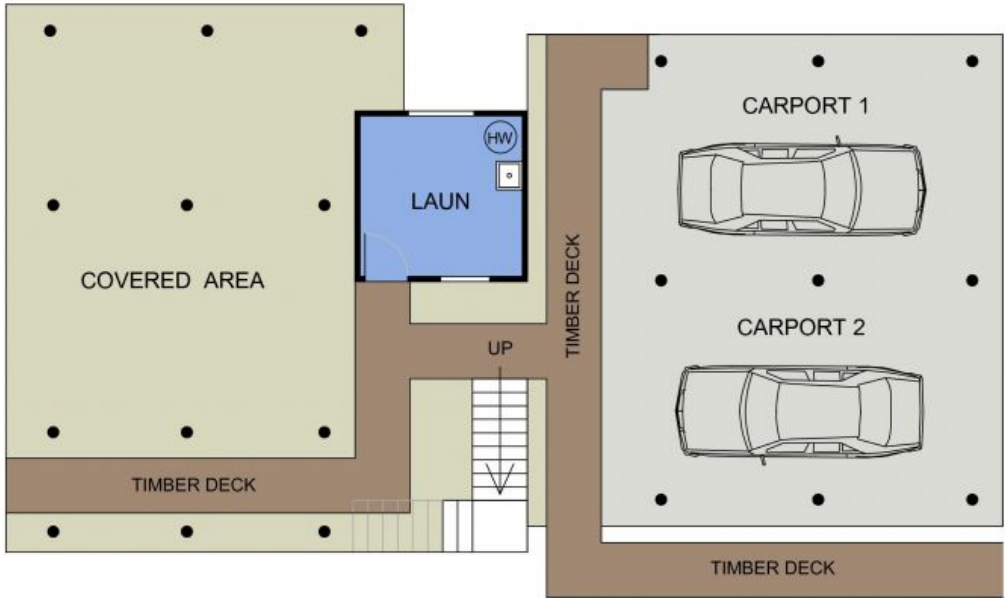

LOWER FLOOR PLAN

314 PLOMER ROAD
NORTH SHORE