



169 Hindman Street Port Macquarie, NSW



4



2



4

Close to Town, Ideal for Family or Tradesman

This is the perfect home for family or tradesman. Positioned on a large triangular shaped 853sqm block with supersized garaging/workshop plus double carport providing ample space for caravan, boat or tradesman. This attractive level living home comprises large open plan living, light filled kitchen and spacious bedrooms, it's the perfect combination with wide verandah surrounding the home, for pets or children to play and a wildlife corridor nearby.

There are so many options for family or tradesman available from this property including gated side access, under house storage,, garden locker and the close proximity to school, TAFE, buses and township make it ideal for all age groups.

Council Rates \$2,500pa

Price: \$535,000

Council Rates: \$2,500.00/year (approx)

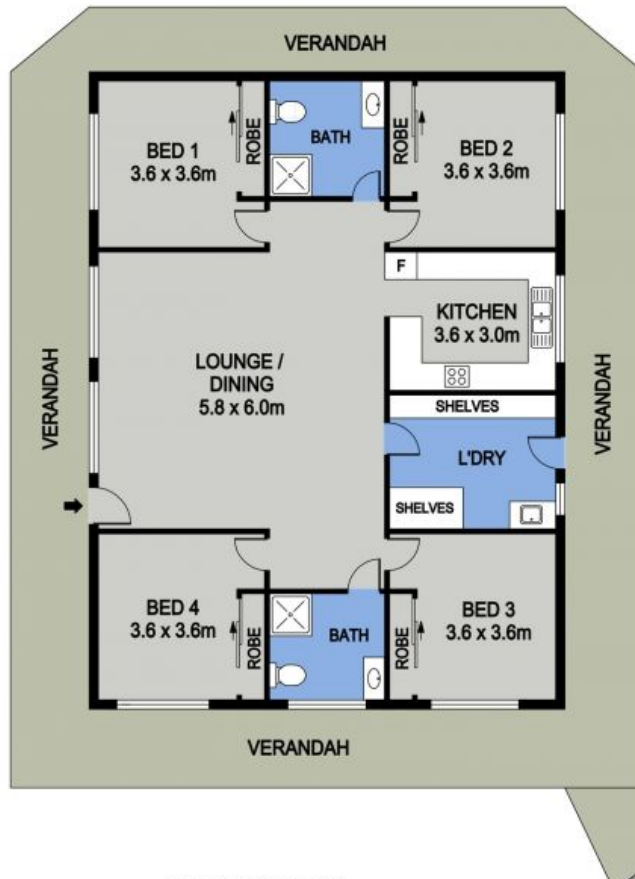

FLOOR PLAN
(229 sq m Approx)

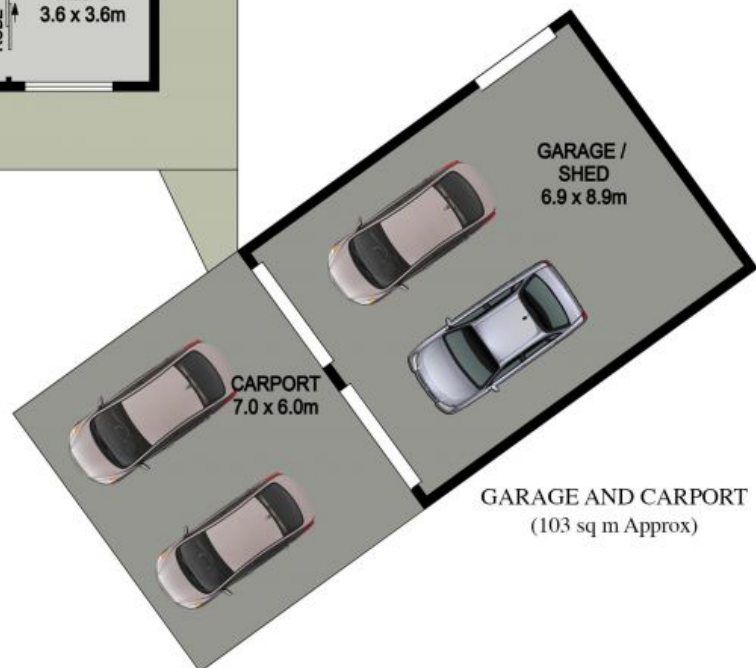

GARAGE AND CARPORT
(103 sq m Approx)

169 HINDMAN ST
PORT MACQUARIE