



995 Lorne Road Lorne, NSW

4 2 9

Executive Class Rural & Riverfront (33 acres - 13.56 hectares)

In the heart of the valley you will arrive at this perfectly proportioned executive class rural property with river frontage, that offers all of the benefits of a rural lifestyle without the workload of larger acreages.

Immediately upon entry you appreciate the quality that is on offer at this magnificent four bedroom home. Featuring a substantial open plan lounge and dining area with high pitched ceilings with celestial windows, an exceptional kitchen with stainless steel appliances and waterfall edged stone benchtops.

Here you will be comfortable throughout all seasons with a slow combustion fire place and ducted air conditioning.

A separate media room provides a second living area, plus two covered and screened veranda...

Price: Guide \$880,000-\$930,000

Council Rates: \$1,960.00/year (approx)



Martin Newell

0429 883 488

Martin Newell

0429 883 488



FLOOR PLAN
(238 sq m Approx)

995 LORNE ROAD
LORNE

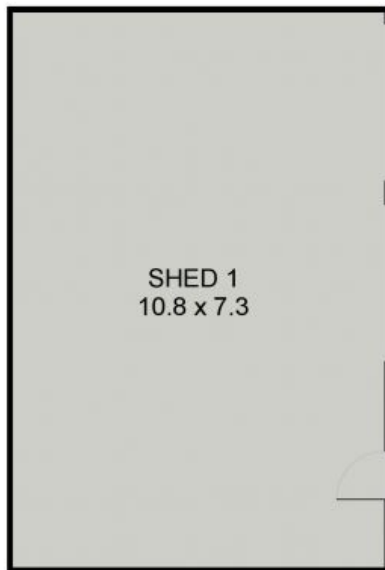

SHED 1

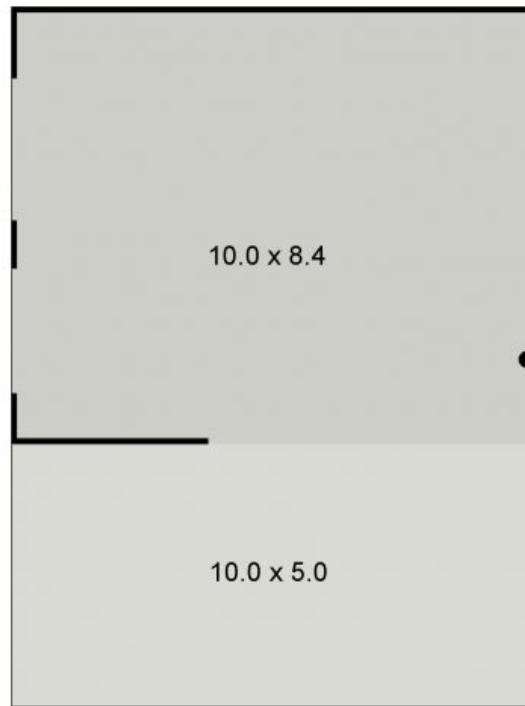

SHED 2

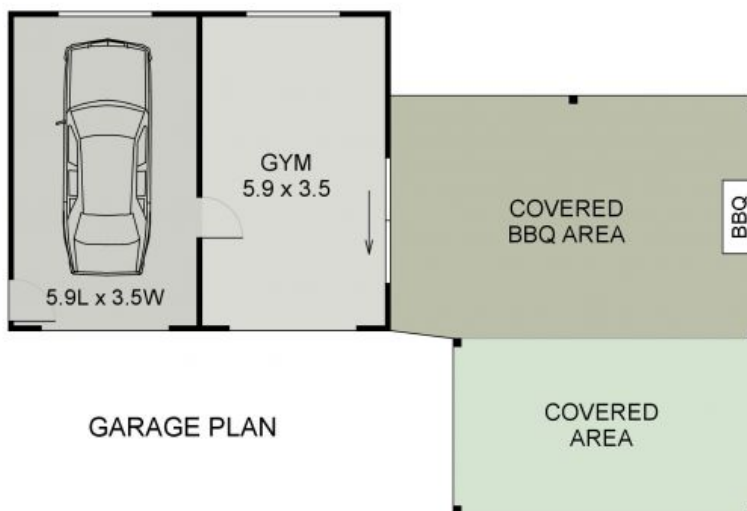

GARAGE PLAN

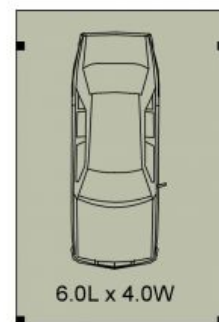

CARPORT

995 LORNE ROAD
LORNE