



**PERCIVAL**  
PROPERTY  
Martin Newell  
Rural & Lifestyle Property



540 Burrawan Forest Drive Lake Innes, NSW

4 3 5

## For Those who Seek an Exceptional Home and Rural Lifestyle

Conveniently located just 19 minutes from the heart of Port Macquarie, it is a brief six minute drive from the Sovereign Hills Town Centre with supermarket, retail and cafes.

Entering the gateway and viewing the newly constructed Federation / Hamptons style home, you realise you have arrived at a property of distinction, further qualified upon entry into the home itself.

Ample accommodation incorporates an expansive master bedroom with an absolutely gorgeous ensuite with floor to ceiling tiles, double vanity and walk-in shower. This sanctuary also incorporates a generous walk-in robe ? a feature shared by a further three extra-large bedrooms. The study offers the opportunity of a fifth bedroom if required. These bedrooms are...

**Price:** Expression of Interest

**Council Rates:** \$2,400.00/year (approx)



**Martin Newell**

0429 883 488

**Martin Newell**

0429 883 488

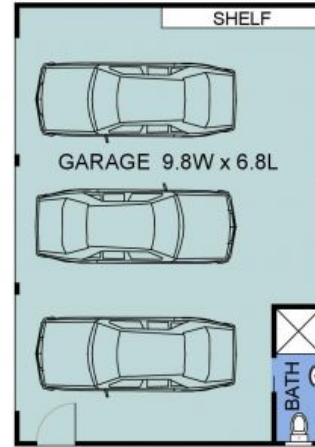
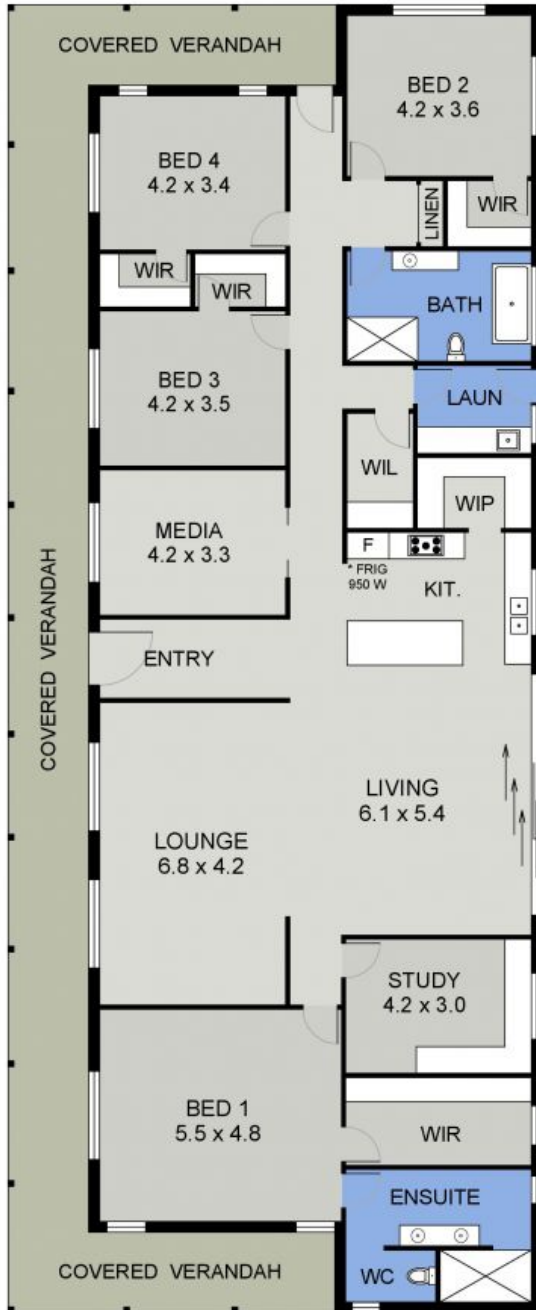

SEPARATE GARAGE

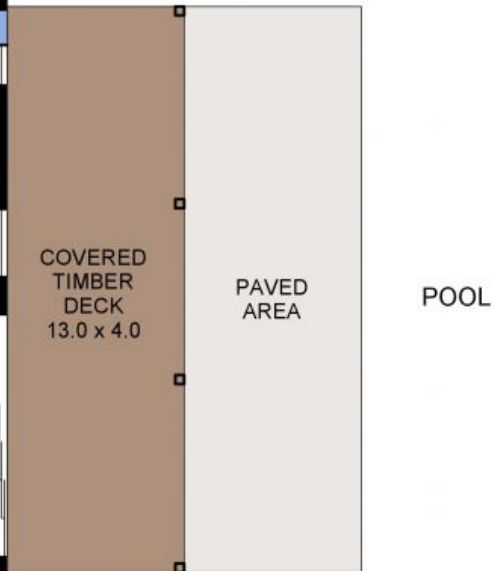

FLOOR PLAN  
(283 sq m Approx)  
Scale - 1:130

540 BURRAWAN FOREST RD  
INNES LAKE