



20 Timber Ridge Port Macquarie, NSW



6



4



2

## Tudor Style Manor with Self Contained Cottage in Elite Enclave

Enjoy the best of coastal living, a peaceful and private sanctuary positioned directly opposite rainforest bushland, just minutes from Lighthouse Beach and Shelly Beach. It's hard to believe this quiet community oriented neighbourhood is only a short drive into the vibrant Town Centre of Port Macquarie with an array of shops, waterfront restaurants and much more. Living here you get to enjoy amazing wildlife at the doorstep, such as koalas and spectacular birdlife.

In addition to the main house is a fully self-contained one-bedroom granny flat, with reverse cycle air conditioning and ceiling fans for modern comforts; perfect for accommodating guests, potential Airbnb, rental income, or separate living quarters for family members. ...

**Price:** Guide \$1,450,000-\$1550,000

**Council Rates:** \$3,900.00/year (approx)

**PERCIVAL**  
PROPERTY

**Tyson Cunningham Corrine Cunningham**

0481 123 047

0409 468 773



**FLOOR PLAN**  
266sqm internal (approx.)

**20 TIMBER RIDGE  
PORT MACQUARIE**



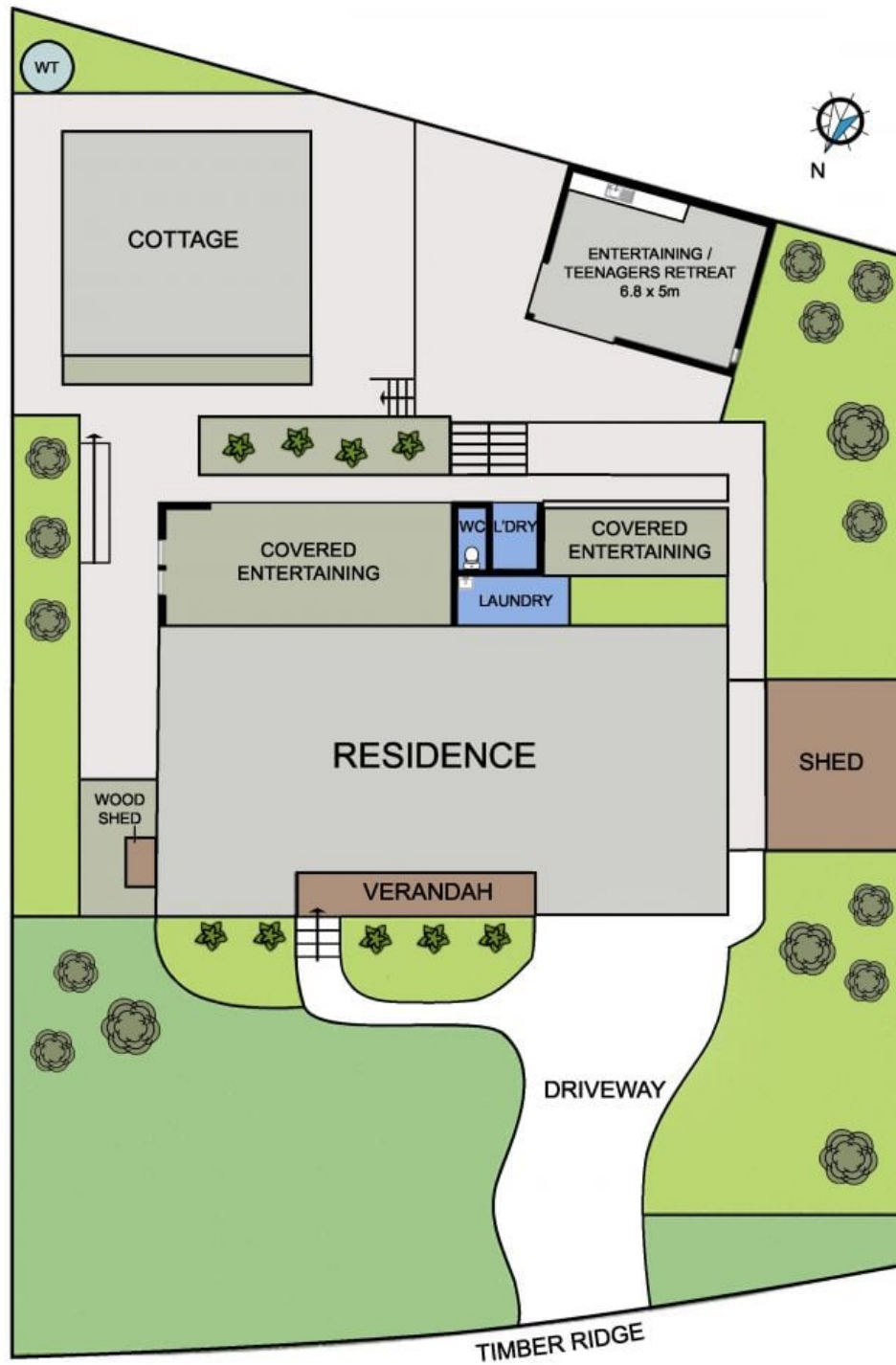

20 TIMBER RIDGE  
PORT MACQUARIE