



30 Montague Street Port Macquarie, NSW



4



2



2

## Lighthouse Beach Haven With Ocean Glimpses

Nestled within this coveted precinct and enjoying ocean glimpses, this home is a gateway to an enviable coastal existence.

This dual-level residence captures refreshing ocean glimpses, reminding you of the boundless beauty just moments away.

**Price:** Guide \$960,000-\$990,000

**Council Rates:** \$3,000.00/year (approx)

**PERCIVAL**  
PROPERTY

**Michelle Percival**

0404 466 500

**Glenn Scott**

0417 019 756



**MAIN FLOOR PLAN**  
(150 sq m Approx)

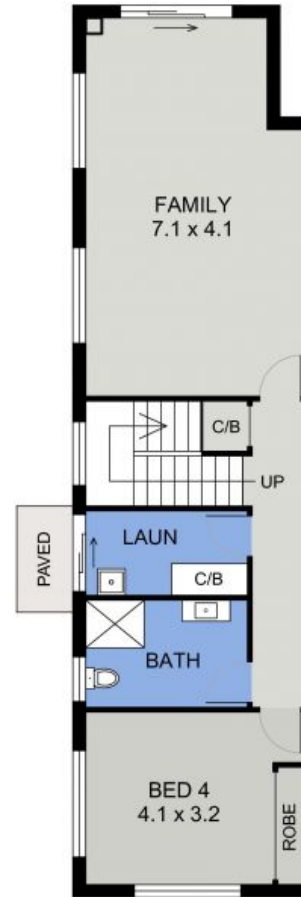

**LOWER FLOOR PLAN**  
(74 sq m Approx)  
Scale - 1:100

**30 MONTAGUE STREET  
PORT MACQUARIE**



DISCLAIMER: Plans shown are for marketing purposes only. All dimensions are approximate, and may be subject to error, therefore no liability will be accepted. Interested parties should make their own enquiries.